

## ZAKOLIČBENE TOČKE

TOČKE	X	Y
T01	545752.055	86770.903
T02	545755.535	86761.647
T03	545754.950	86750.359
T04	545755.540	86743.342
T05	545757.399	86726.146
T06	545759.484	86711.167
T07	545760.896	86703.015
T08	545763.447	86692.703
T09	545766.370	86688.294
T10	545770.790	86687.005
T11	545782.434	86686.662
T12	545788.014	86685.996
T13	545806.487	86685.649
T14	545823.348	86685.430
T15	545832.353	86685.892
T16	545834.760	86686.038
T17	545834.765	86692.288
T18	545855.841	86692.606
T19	545855.940	86686.029
T20	545863.092	86686.007
T21	545864.320	86687.025
T22	545866.599	86691.304
T23	545868.580	86695.100
T24	545874.580	86695.136
T25	545877.631	86689.890
T26	545880.428	86685.909
T27	545892.004	86685.999
T28	545899.065	86685.991
T29	545917.870	86685.373
T30	545924.743	86685.885
T31	545942.208	86690.657
T32	545952.663	86696.676
T33	545966.834	86700.140
T34	545966.788	86650.140
T35	545960.529	86646.719
T36	545954.606	86636.390
T37	545945.725	86636.365
T38	545943.729	86636.500
T39	545941.582	86639.866
T40	545941.080	86643.922
T41	545940.985	86647.801
T42	545940.908	86651.739
T43	545940.756	86659.247
T44	545940.426	86660.878
T45	545940.103	86661.304
T46	545933.840	86662.529
T47	545925.299	86663.584
T48	545915.303	86664.001
T49	545895.606	86664.263
T50	545880.025	86664.514
T51	545877.065	86659.951
T52	545874.826	86654.041
T53	545868.826	86654.005
T54	545865.579	86660.146
T55	545863.057	86663.068
T56	545858.794	86663.084
T57	545850.876	86662.978
T58	545845.763	86662.004
T59	545842.745	86661.820
T60	545837.010	86659.492
T61	545830.328	86659.492
T62	545827.902	86662.733
T63	545818.401	86662.755
T64	545796.360	86662.253
T65	545788.746	86662.208
T66	545785.160	86661.695
T67	545781.812	86661.360
T68	545773.243	86661.024
T69	545770.461	86660.754
T70	545767.182	86659.890
T71	545764.825	86657.958
T72	545763.636	86656.525
T73	545762.453	86652.572
T74	545744.342	86650.561
T75	545742.895	86652.679
T76	545741.536	86654.013
T77	545739.732	86657.234
T78	545737.902	86659.334
T79	545735.229	86660.492
T80	545731.341	86660.997
T81	545728.176	86661.632
T82	545727.090	86663.721
T83	545725.498	86678.063
T84	545725.610	86681.140
T85	545733.340	86682.010
T86	545735.880	86682.300
T87	545736.654	86687.981
T88	545735.938	86698.412
T89	545735.708	86705.546
T90	545732.540	86737.362
T91	545728.020	86751.220
T92	545724.137	86753.558
T93	545724.098	86756.912
T94	545732.394	86762.832
T95	545736.201	86766.713
T96	545741.388	86772.095

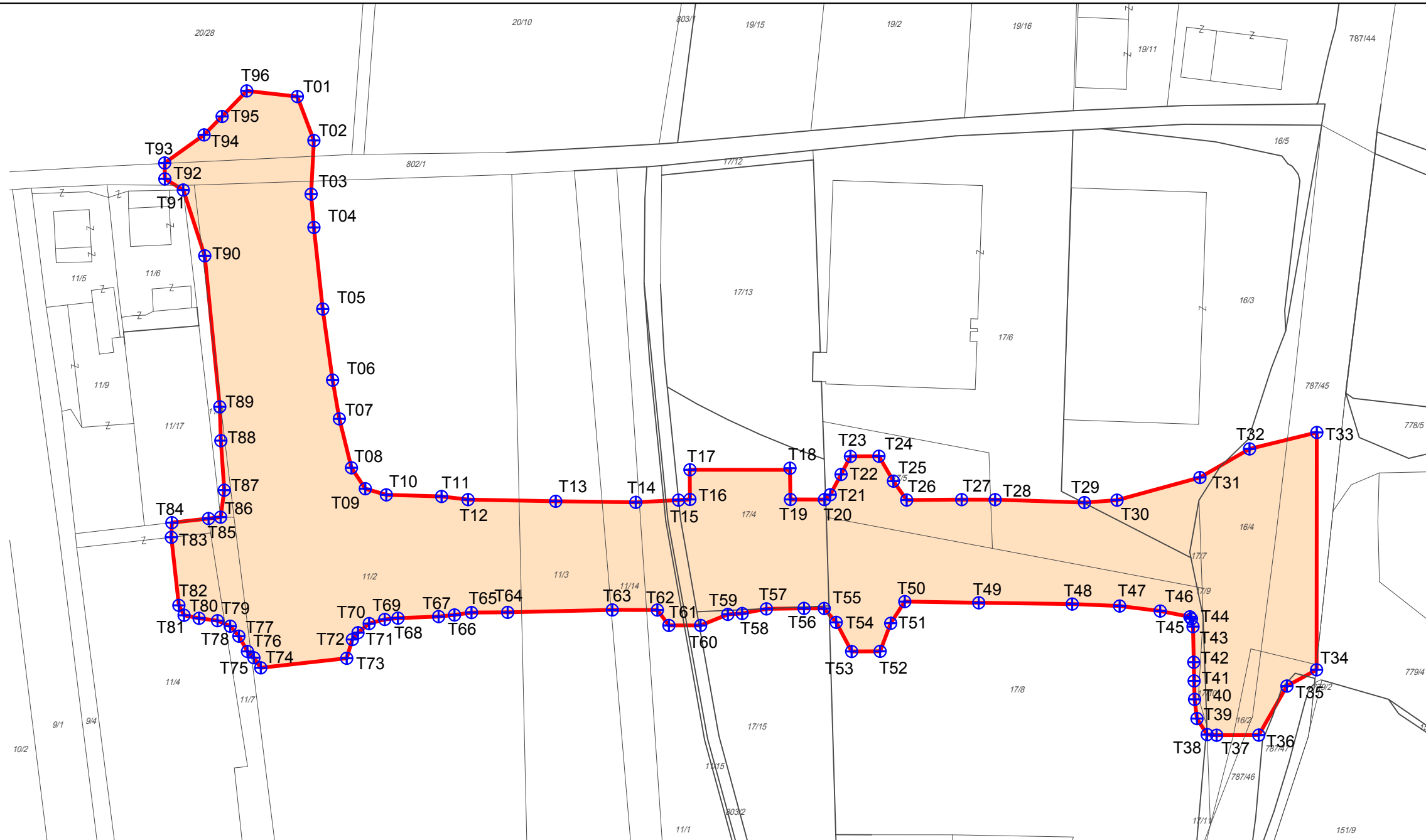

### LEGENDA:

- meja OPPN
- nova parcela za cesto

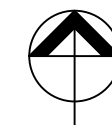

podloga: geodetski načrt, Geodetski biro d.o.o., 358-2021-3, december 2021

naročnik: Občina Brežice

načrtovalec: **ACER**  
ACER Novo mesto d.o.o.

vodja naloge: SUZANA SIMIČ, univ.dipl.inž.kraj.arh., ZAPS KA-0847

sodelavci: mag. JELKA HUDOKLIN, univ.dipl.inž.kraj.arh., ZAPS KA-0850  
mag. RADOVAN NIKIČ, univ.dipl.inž.grad., IZS G-0324  
LUCIJA GRITLI, univ.dipl.inž.kraj.arh.

naloga: OBČINSKI PODROBNI PROSTORSKI NAČRT  
ZA NAVEZOVALNO CESTO ŠENTLENART BREŽICE

št. naloge: S-01/21

faza: SPREJET DOKUMENT

datum: februar 2022

grafični prikaz

merilo: 1:1.000

št. lista:

NAČRT GRADBENIH PARCEL

1:1.000

8